

Ashby Fixing

Info & Tech

Stand Off Connectors

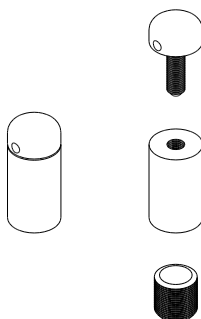

Small Stand Off Connector

Product Code: SOCSC (Chrome) SOCSS (Satin)
Panel Hole Size: 5.0mm - 6mm
Panel Thickness: 1mm - 10mm
Fixing Hole Size: 4mm
Overall Dimensions: 25mm (Tall) x 12mm (Diameter)

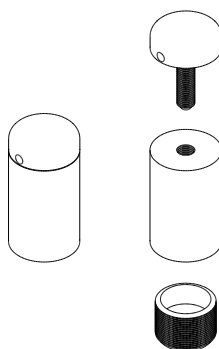

Medium Stand Off Connector

Product Code: SOCMC (Chrome) SOCMS (Satin)
Panel Hole Size: 5.0mm - 6mm
Panel Thickness: 1mm - 10mm
Fixing Hole Size: 6mm
Overall Dimensions: 31mm (Tall) x 16mm (Diameter)

Available in Chrome or Satin
Finishes in all sizes.

Tel: 0118 981 5343

8:00am - 6:00pm, Monday to Friday

sales@ashbytrade.co.uk

www.ashbytrade.net

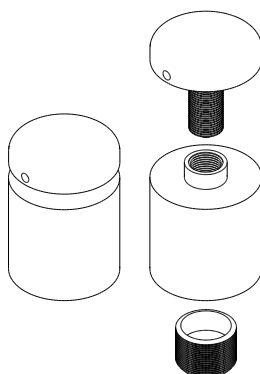

Large Stand Off Connector

Product Code: SOCLC (Chrome) SOCLS (Satin)
Panel Hole Size: 10mm - 11mm
Panel Thickness: 5mm - 20mm
Fixing Hole Size: 6mm
Overall Dimensions: 31mm (Tall) x 16mm (Diameter)



Small Stand Off Connector

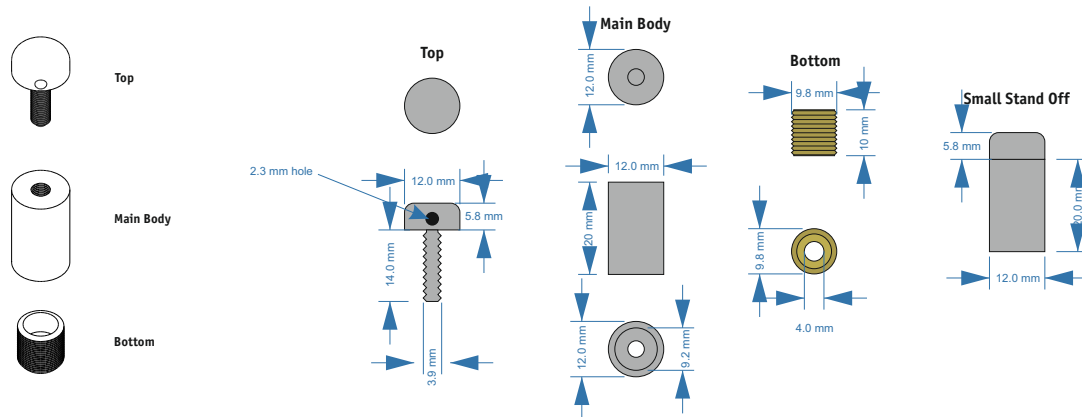

Medium Stand Off Connector

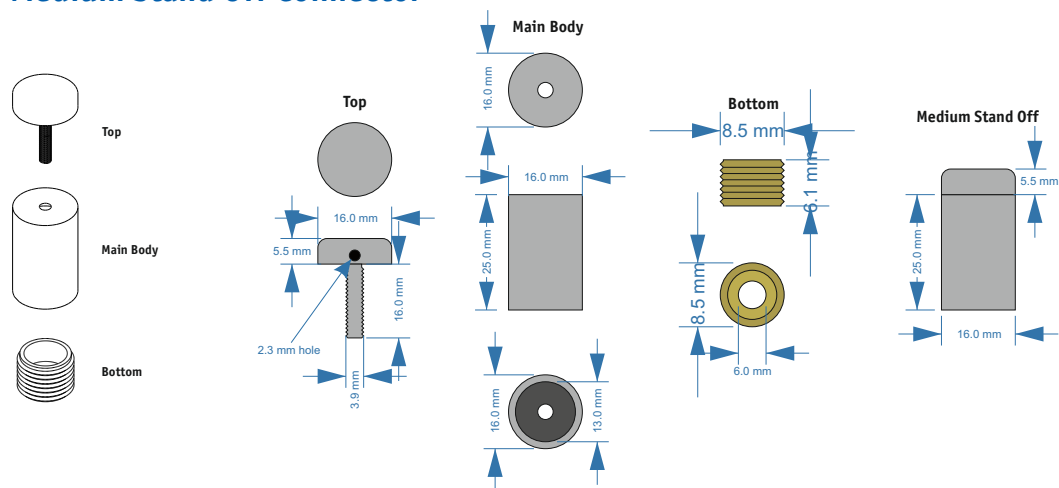

Large Stand Off Connector

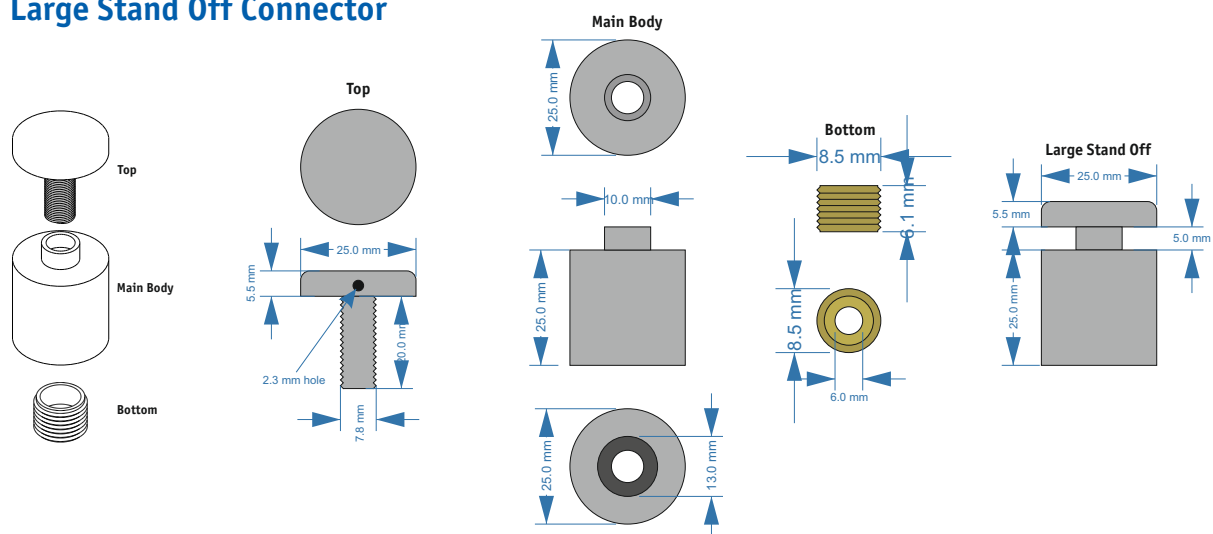

Fitting a Wall mounted acrylic sign with Stand off connectors Version

1. Place the panel into the position you require it and mark the positions of the holes on the wall

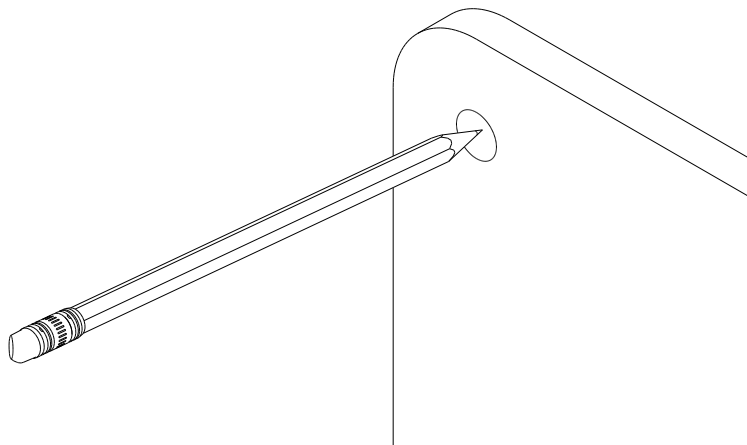

2. Now screw the small internal brass section of the Stand off connector to the wall in the position of the hole marks

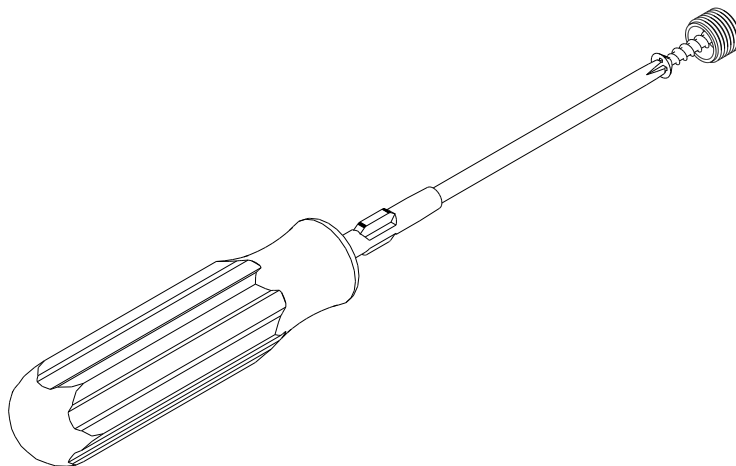

3. Screw the Main bodies of the Standoff connector over the top of the wall mounted brass sections.

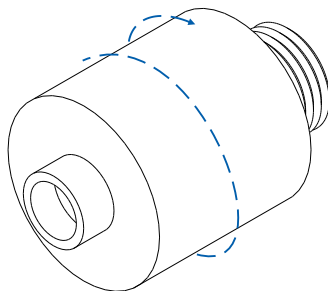

4. Place the holes of the panel over the body of the Stand off connector (Wall mounted), then simply screw of the top section of the Stand off to hold the panel in place.

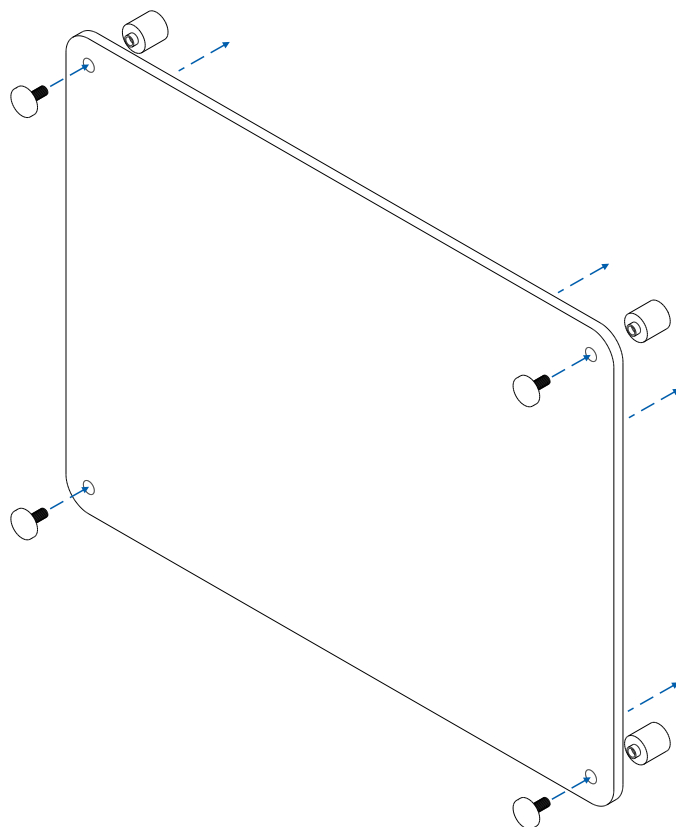

5. Job Done!!!

