

Tools Required

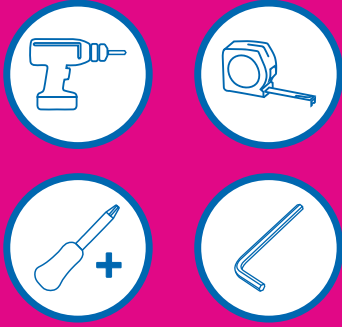

STRYDER_{v2} TROUGH LIGHT

Wall Fitting Diagram

1. Mount the Brackets to the Wall in the desired position

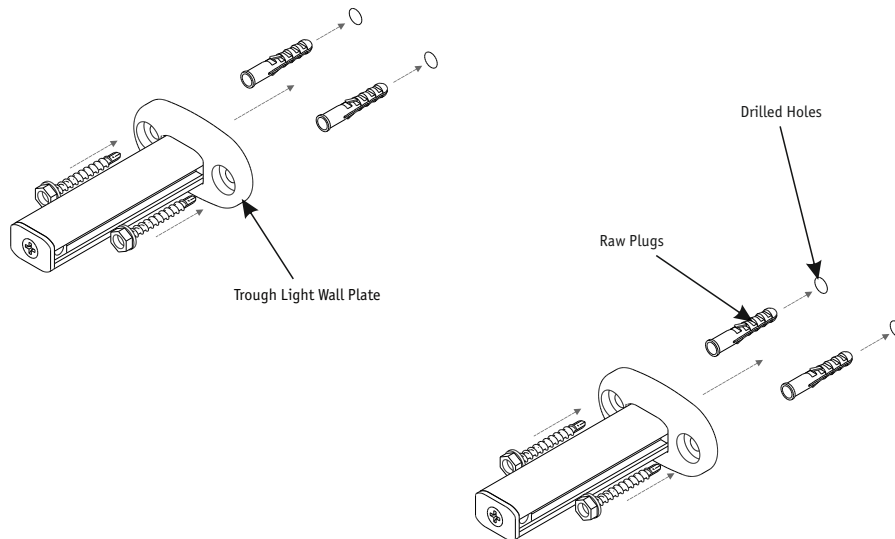

2. Slot the sliders (mounted on the troughlight) over the wall bracket arms and bolt into place using the tooth washers & M6 Bolts

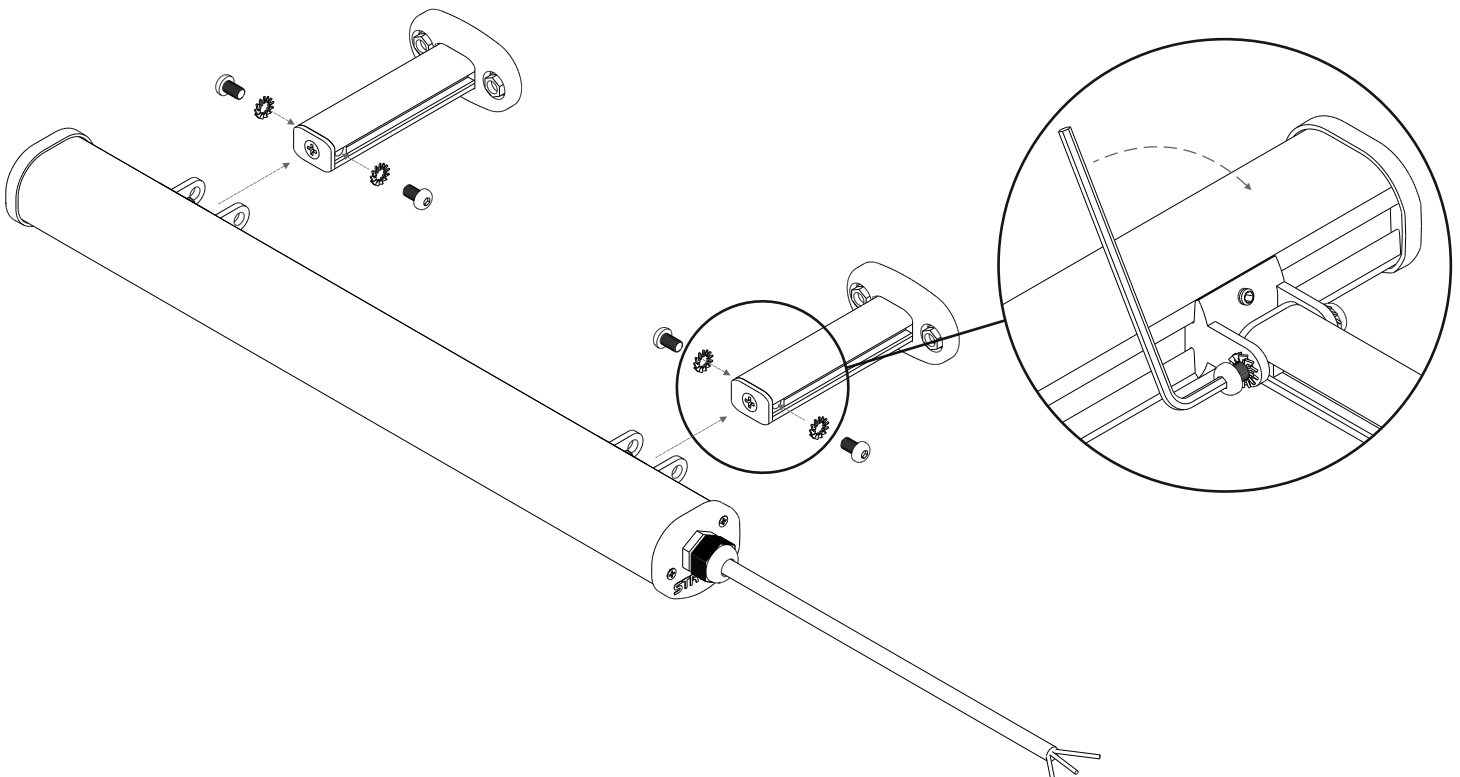

3. Slide the trough light into position, then tighten the Grub Screws in the Slider Bracket to clamp the trough light into place.

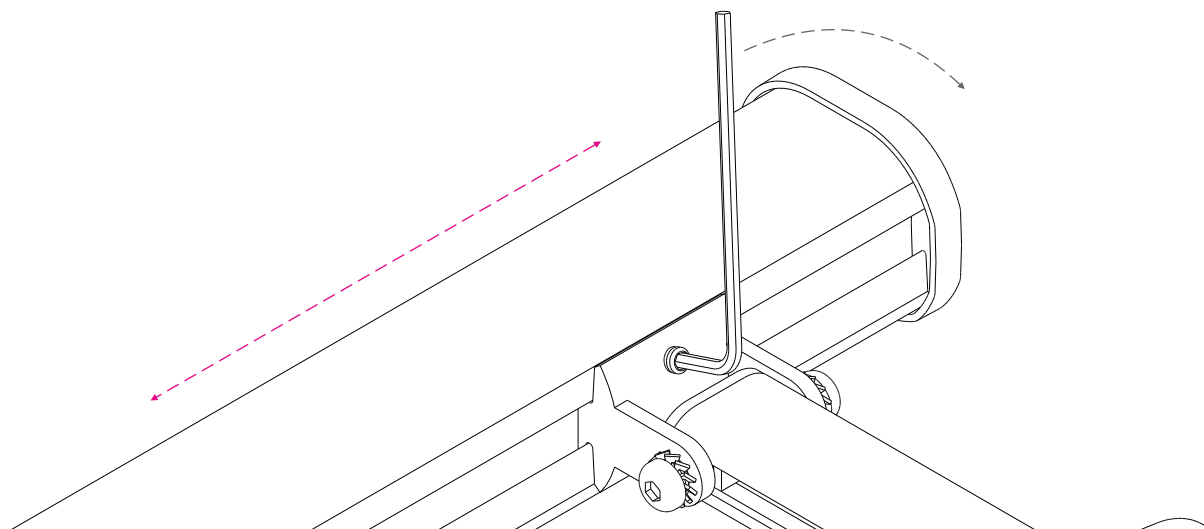

4. Connect the 3-core cable and the troughlight is complete - Get a qualified electrician to connect your 240V Cable to Mains

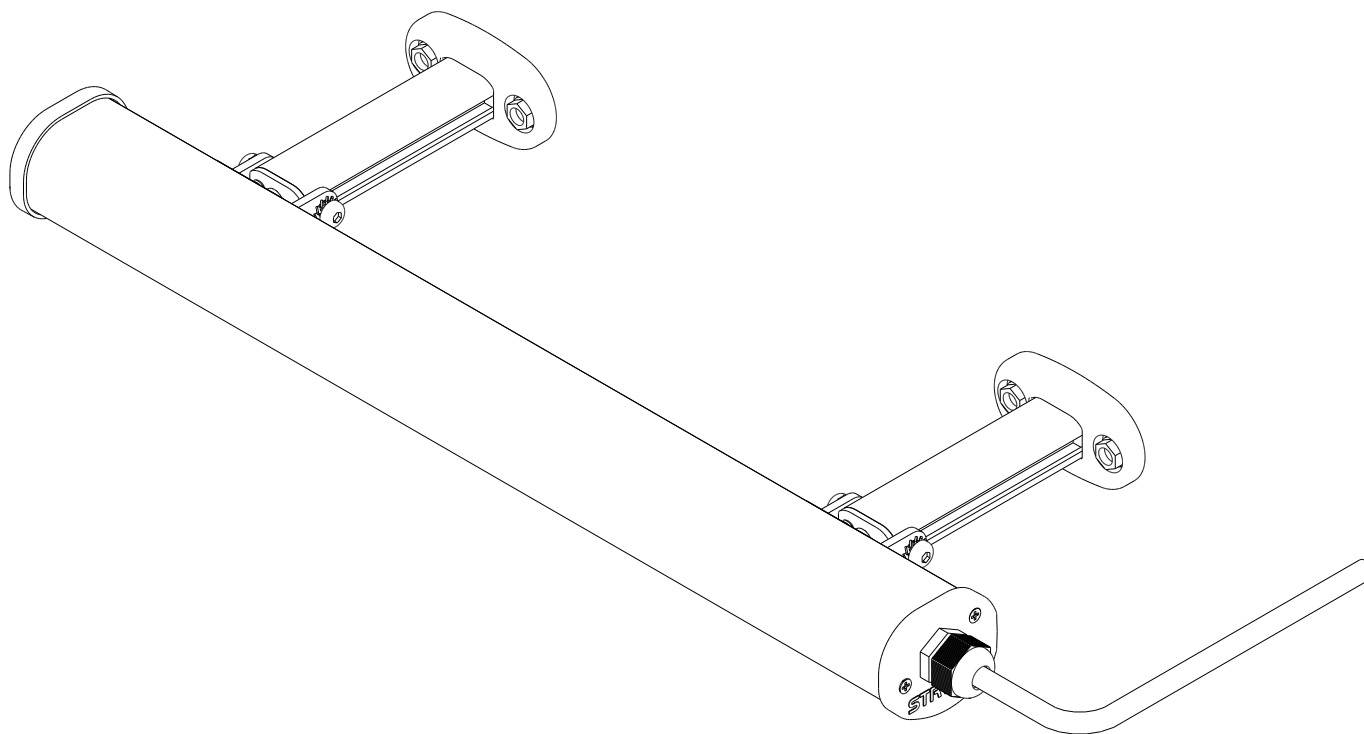

Tools Required

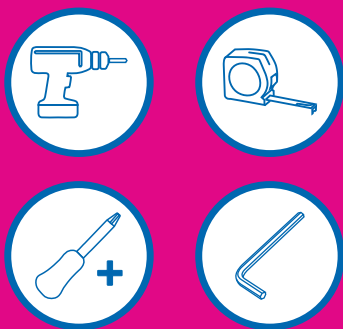

STRYDER_{v2} TROUGH LIGHT WITH JOINING CONNECTOR

Wall Fitting Diagram

1. Fixing the Brackets to the Wall in the desired position

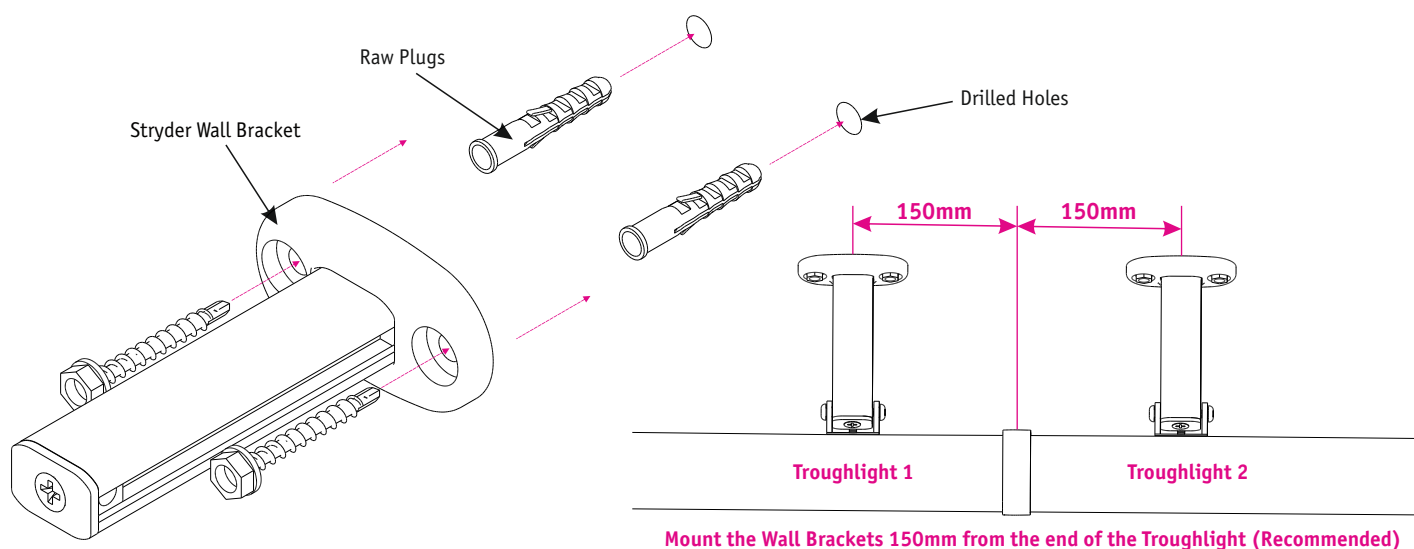

2. Slot the sliders (mounted on the troughlight) over the wall bracket arms and bolt into place using the tooth washers & M6 Bolts

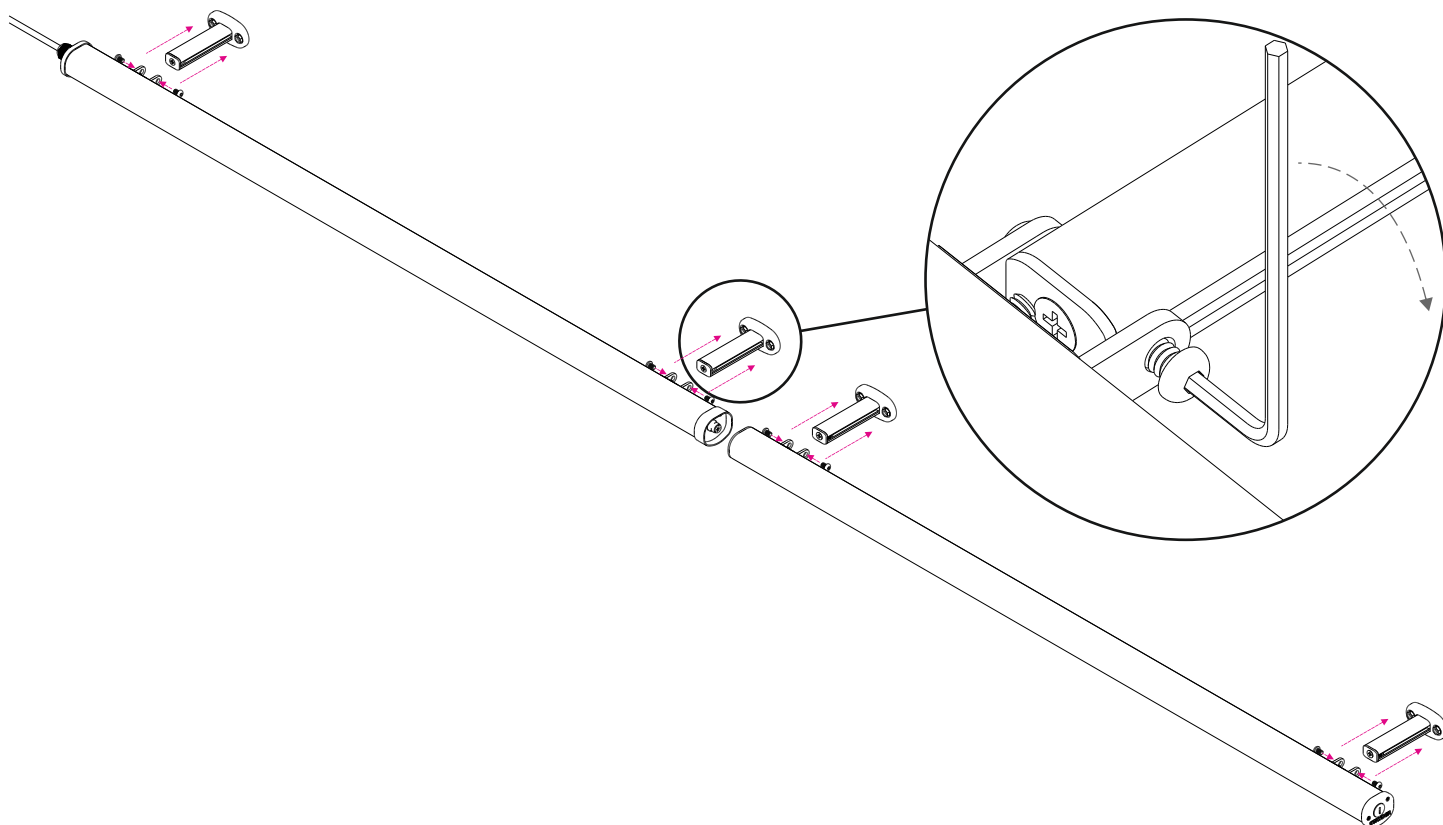

3. Slide the Troughlight along the brackets and Female electrical connection onto the Male Connector.

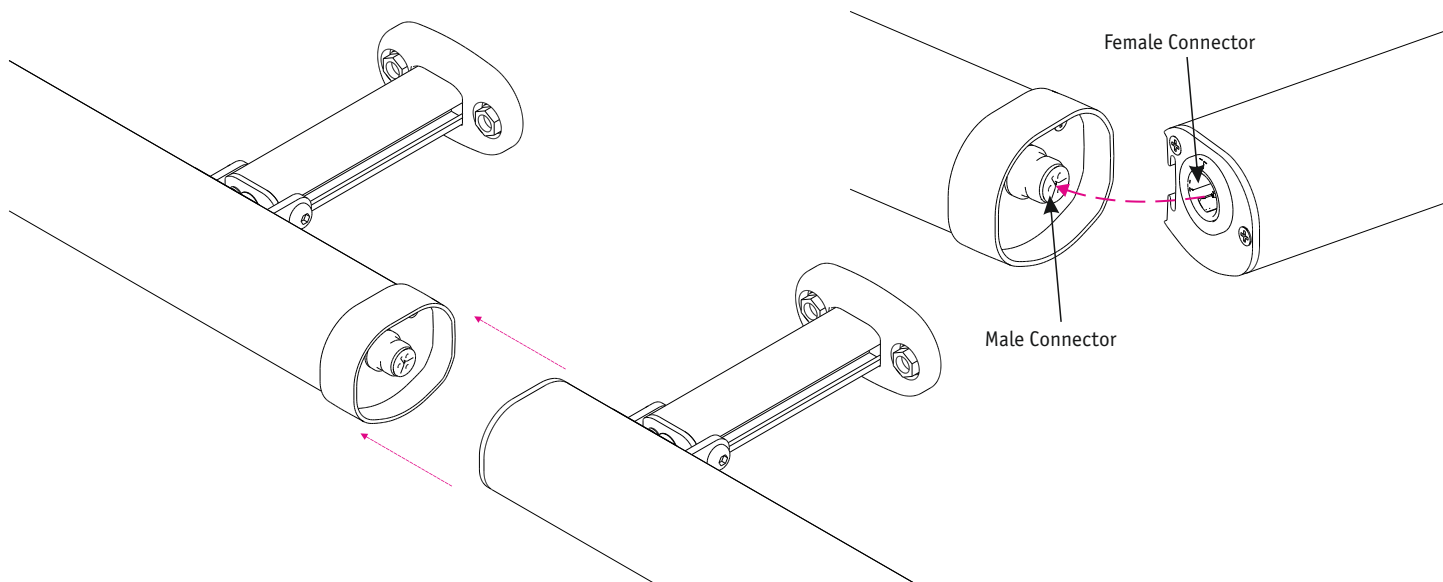

4. Tighten the Grub Screws in the Slider Bracket to clamp the Troughlights into place.

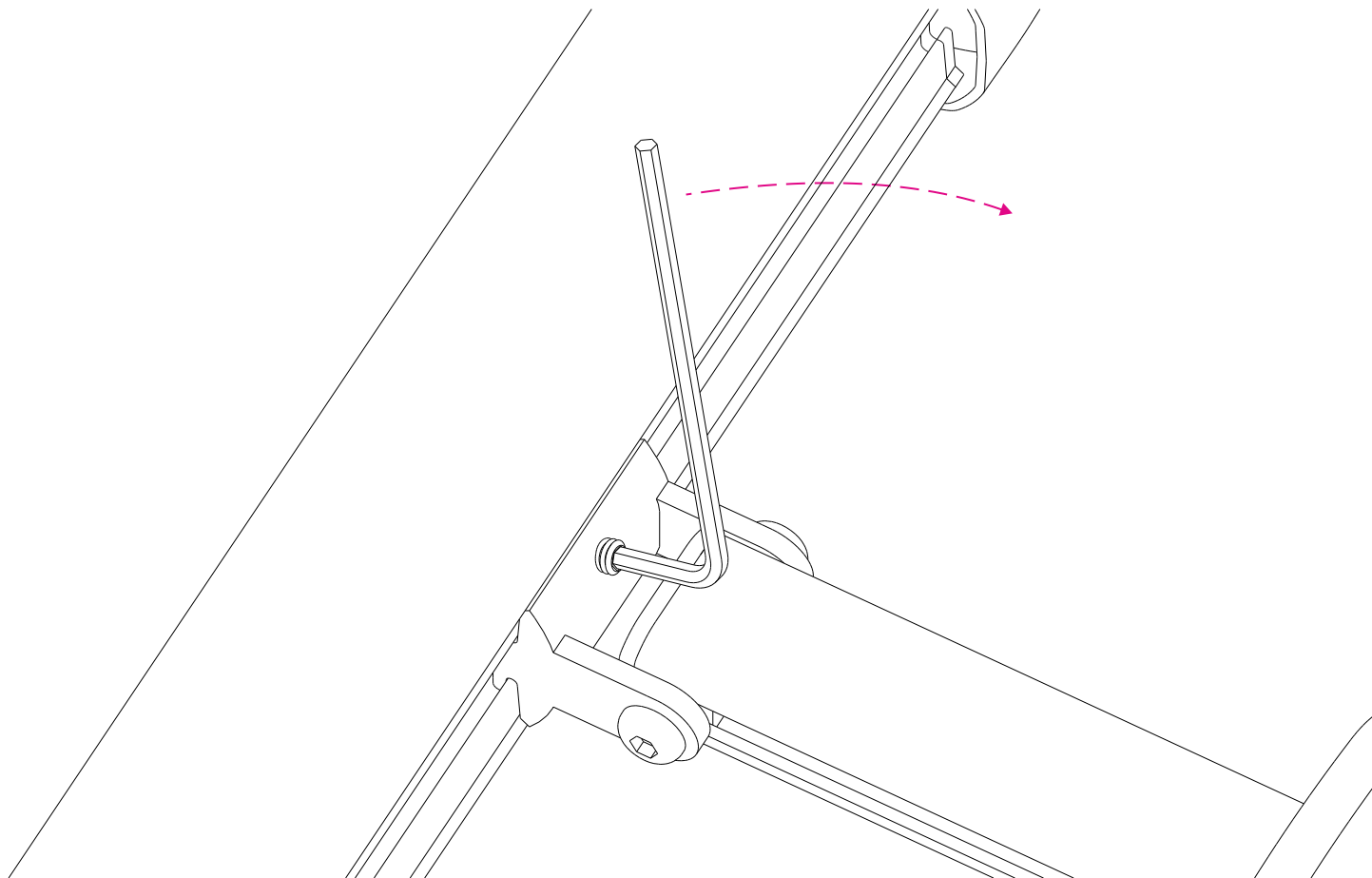

5. Connect the 3-core cable and the troughlight is complete - Get a qualified electrician to connect your 240V Cable to Mains

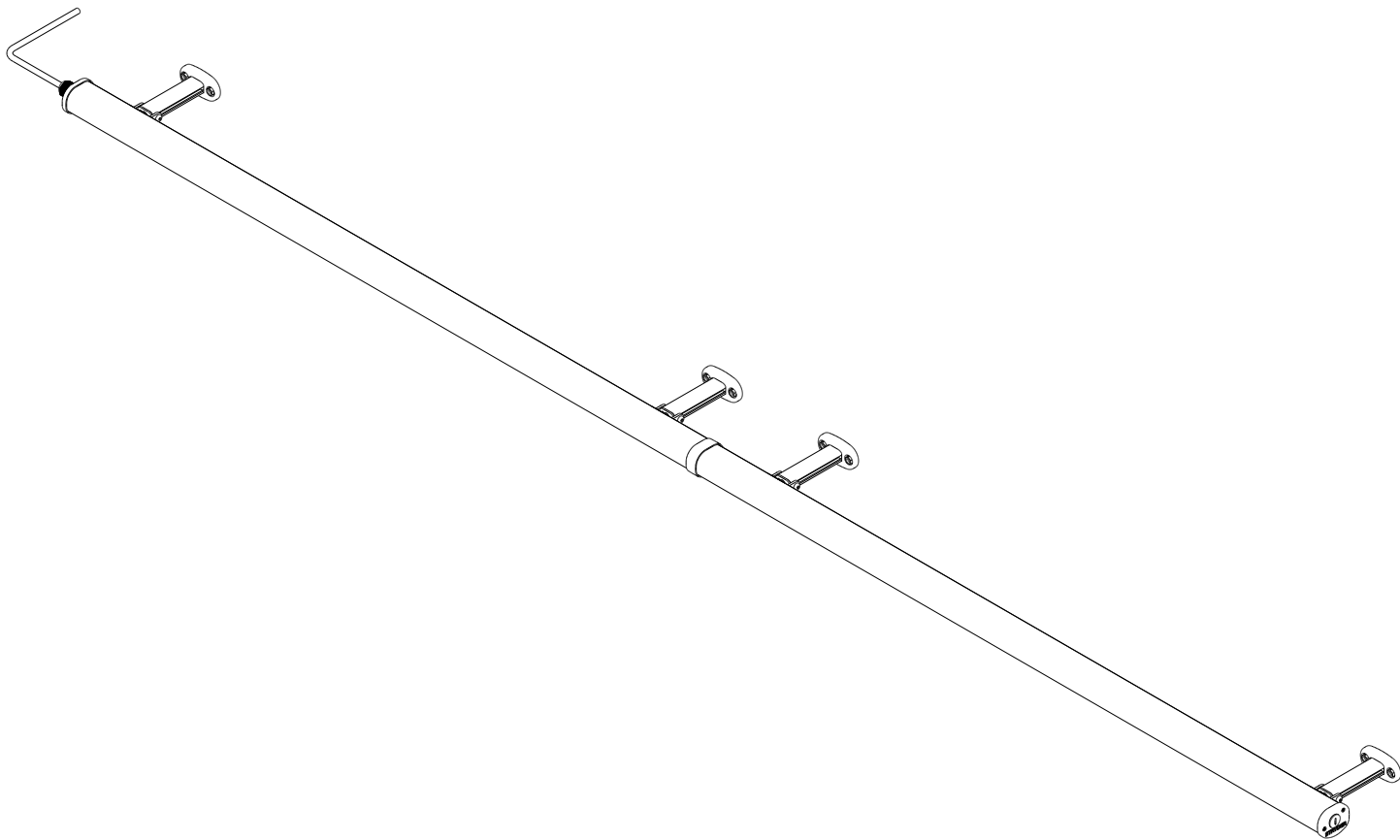

Tools Required



STRYDER_{v2} TROUGH LIGHT

Channel Bracket Fitting Diagram

1. Fixing the Brackets to the Channel on the back of the panel in the desired position.

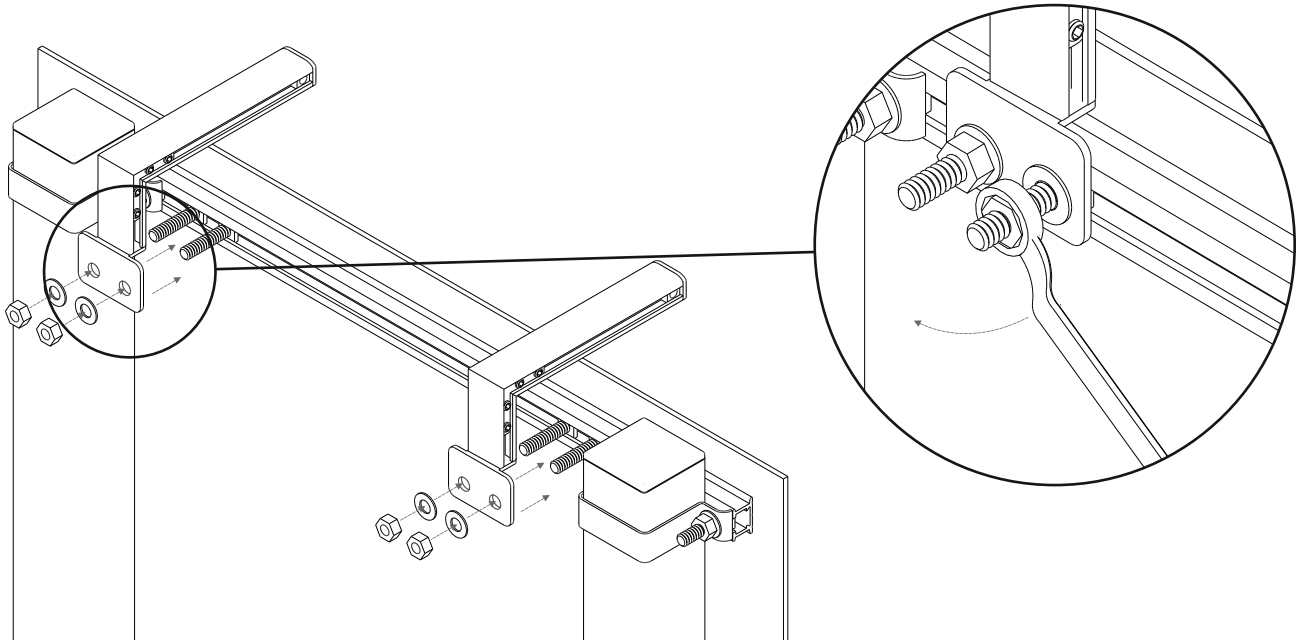

2. Slot the sliders (mounted on the troughlight) over the Channel bracket arms and bolt into place using the and external tooth washers / M6 Bolts

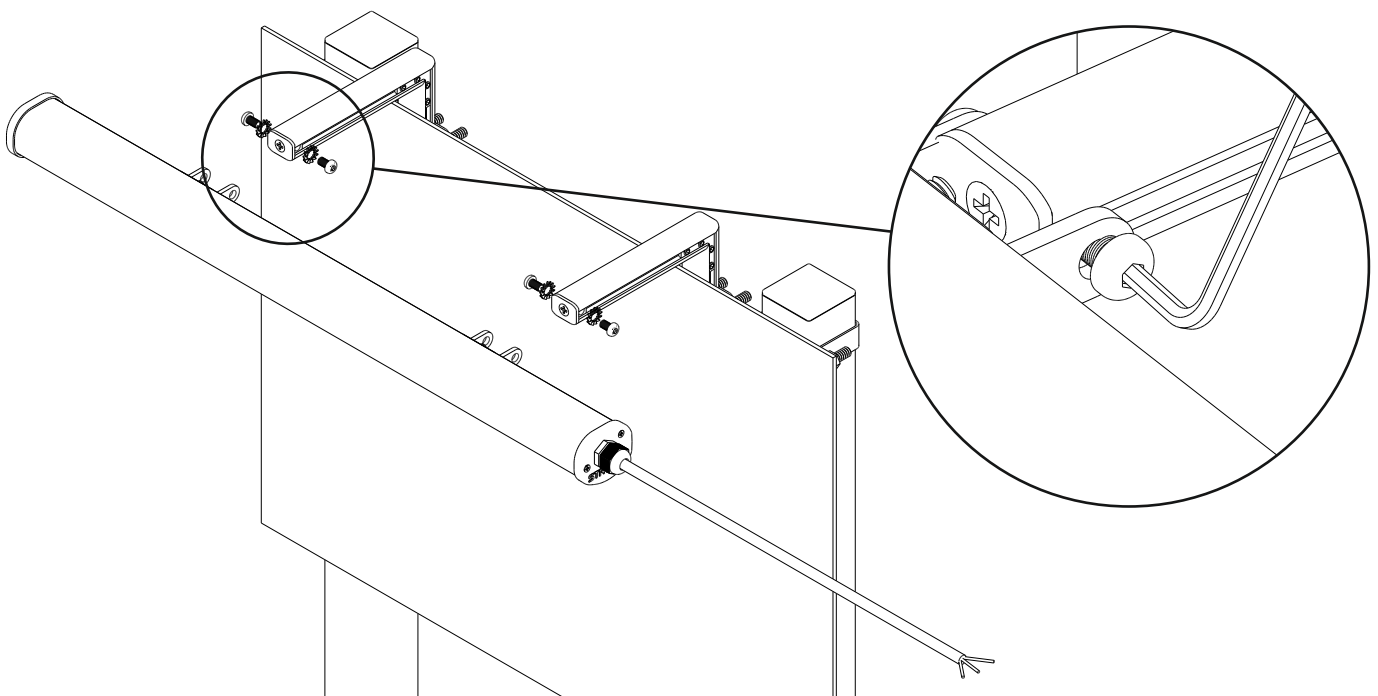

3. Tighten the Grub Screws in the Slider Bracket to clamp the Troughlights into place.

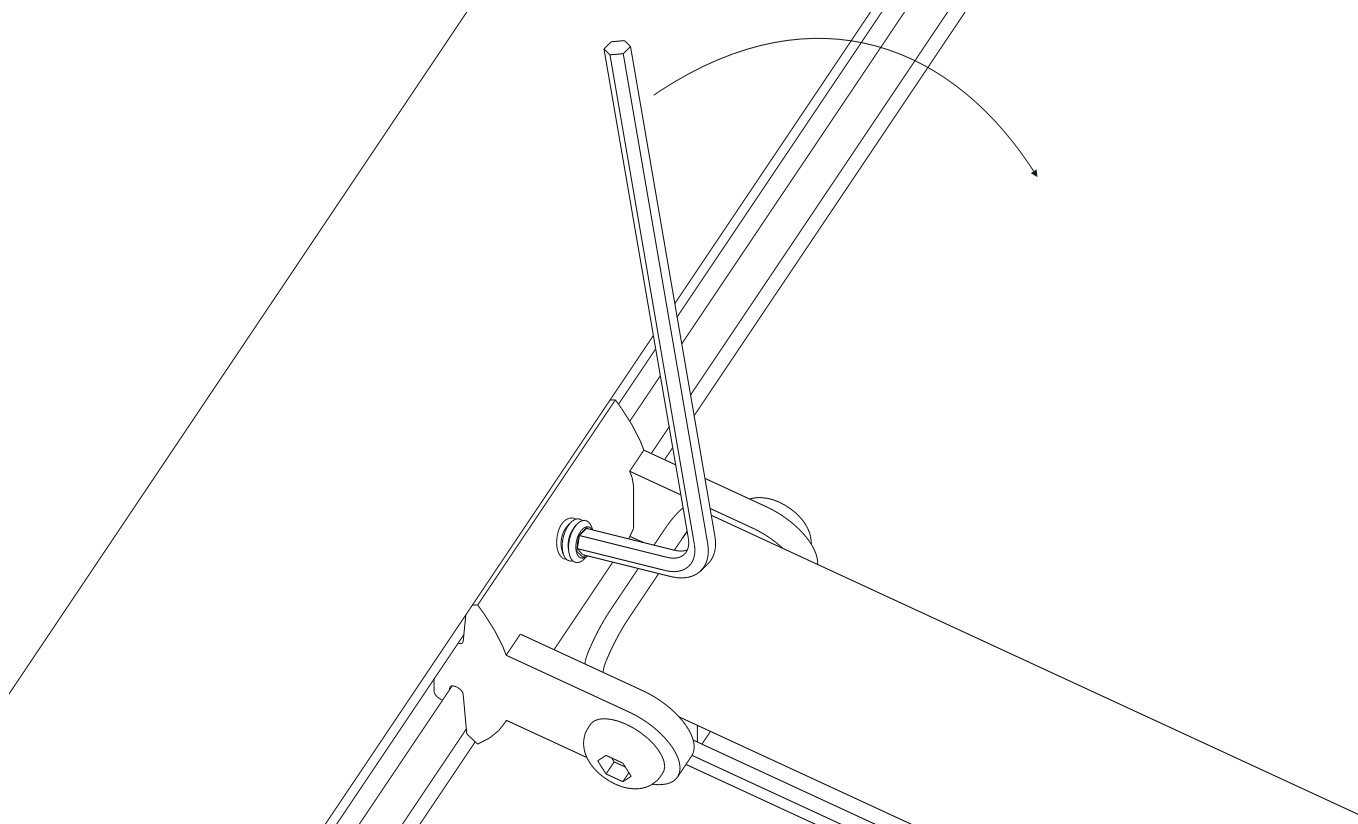

4. Connect the 3-core cable and the troughlight is complete - Get a qualified electrician to connect your 240V Cable to Mains

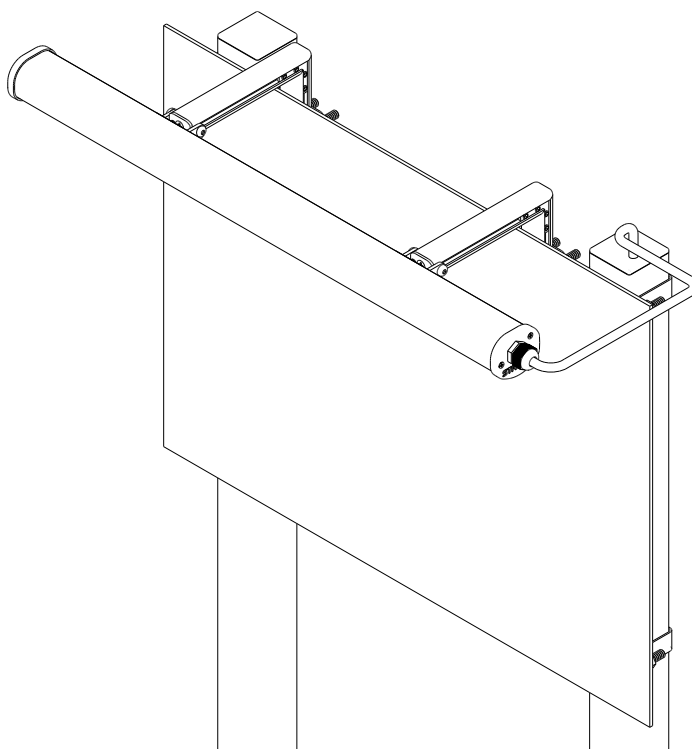

Tools Required



STRYDER_{v2} TROUGHLIGHT

Tray Top Bracket Fitting Diagram

1. Place the Tray Brackets to the Tray in the desired position, Drill holes then rivet or bolt into place.

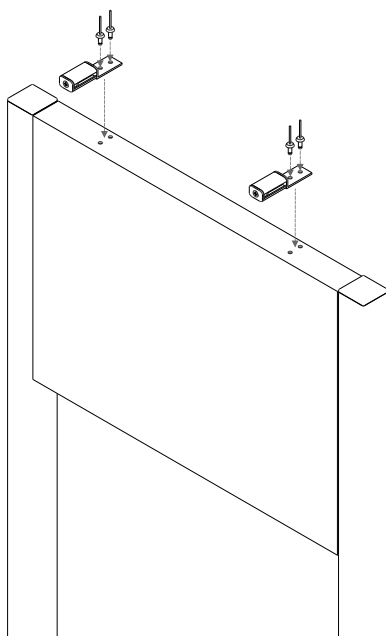

2. Slot the sliders (mounted on the troughlight) over the tray bracket arms and bolt into place using the M6 Bolts

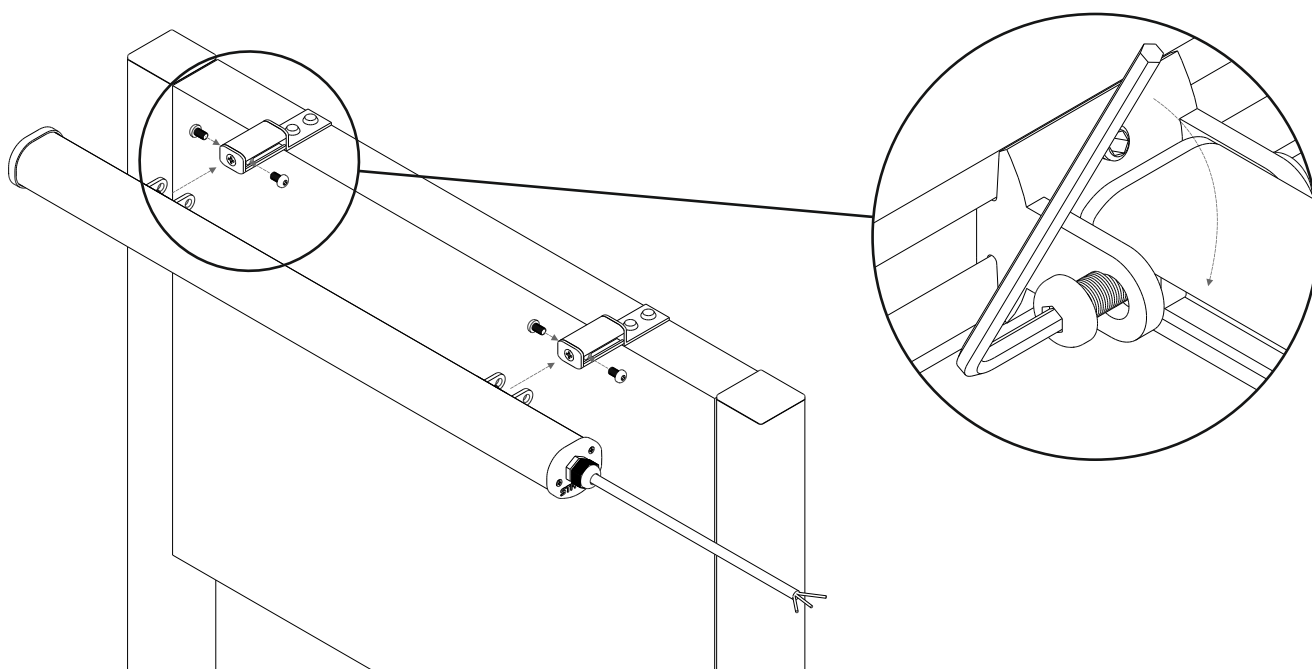

3. Tighten the Grub Screws in the Slider Bracket to clamp the Troughlights into place.

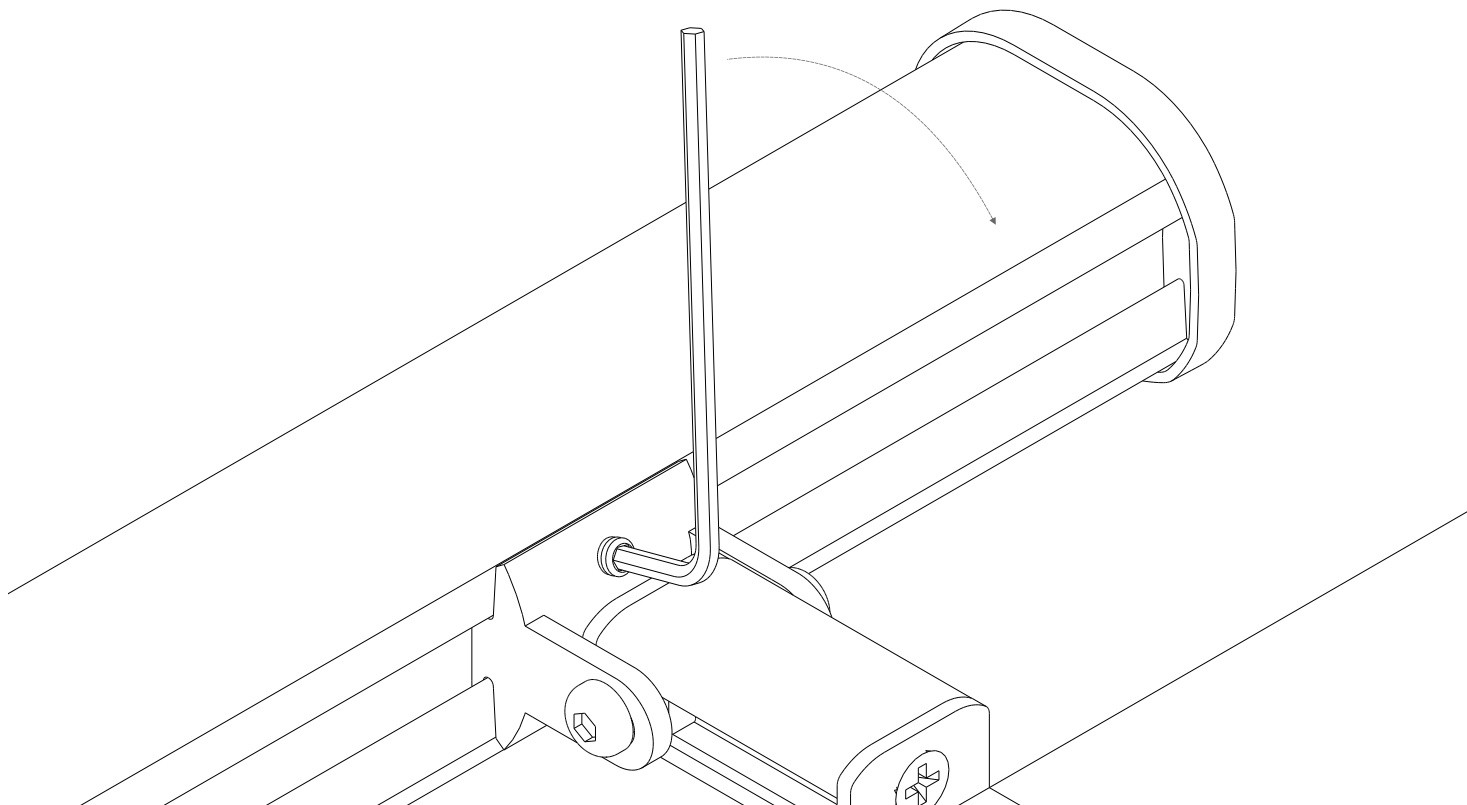

4. Connect the 3-core cable and the troughlight is complete - Get a qualified electrician to connect your 240V Cable to Mains

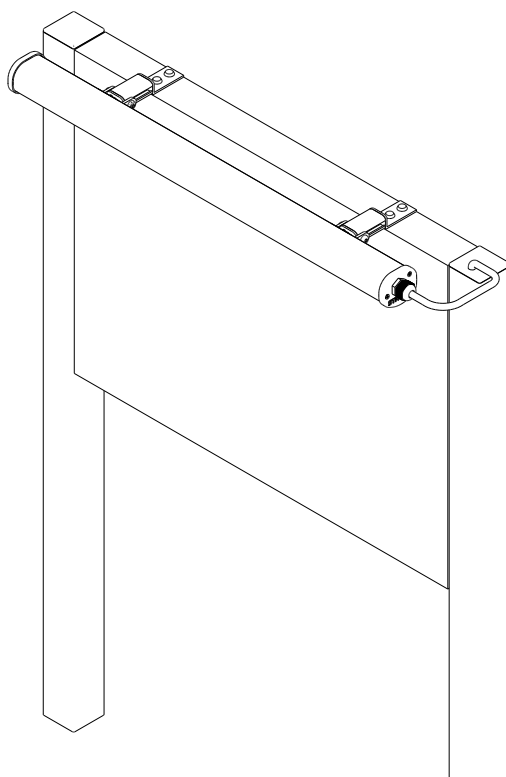

Tools Required



STRYDER_{v2} TROUGHLIGHT

Plate Bracket Fitting Diagram

1. Place the Plate Brackets to the Plate in the desired position,
Drill holes then rivet or bolt into place

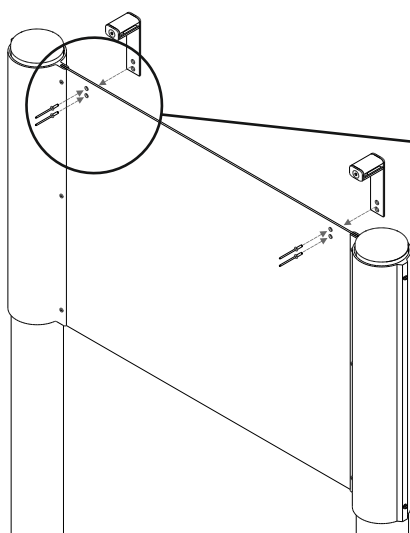

2. Slot the sliders (mounted on the troughlight) over the plate bracket arms and bolt into place using the M6 Bolts

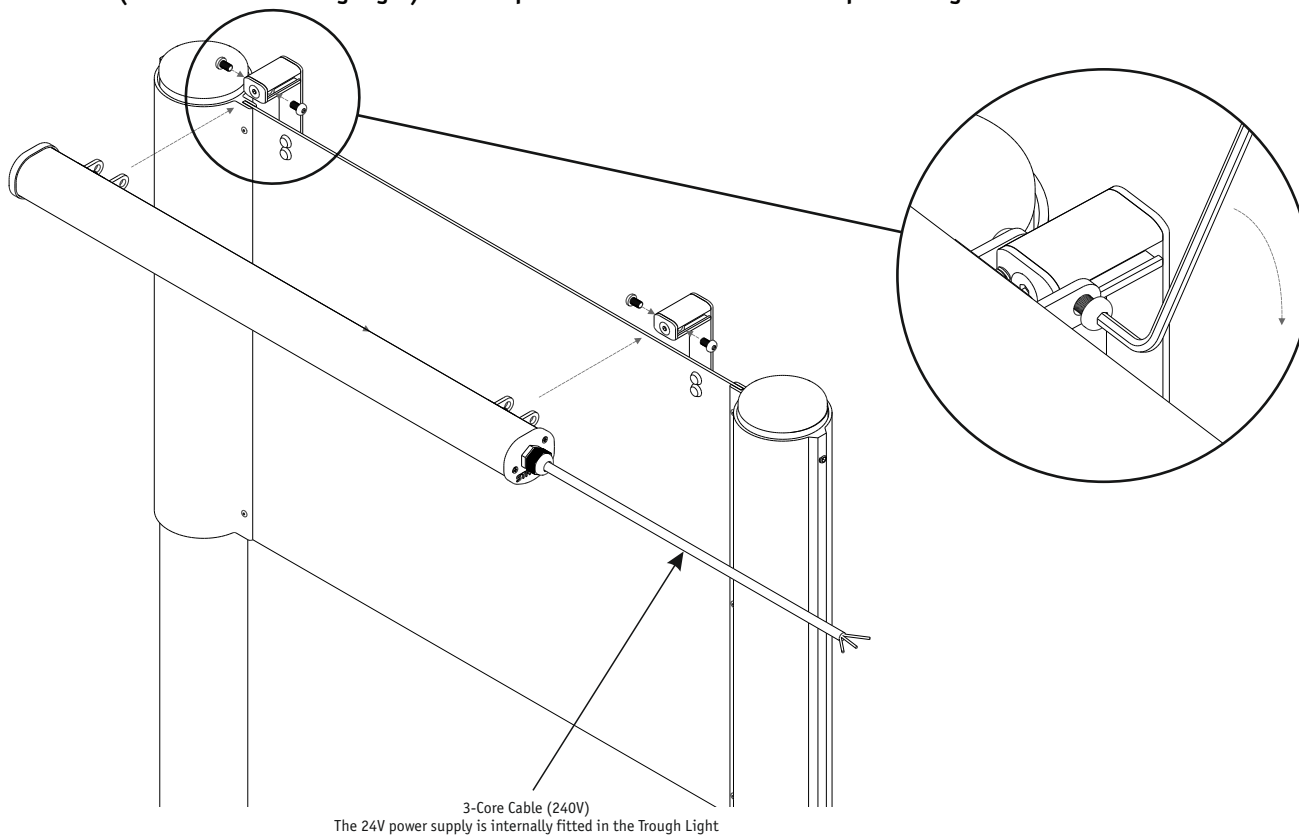

3-Core Cable (240V)
The 24V power supply is internally fitted in the Trough Light



3. Tighten the Grub Screws in the Slider Bracket to clamp the Troughlights into place.

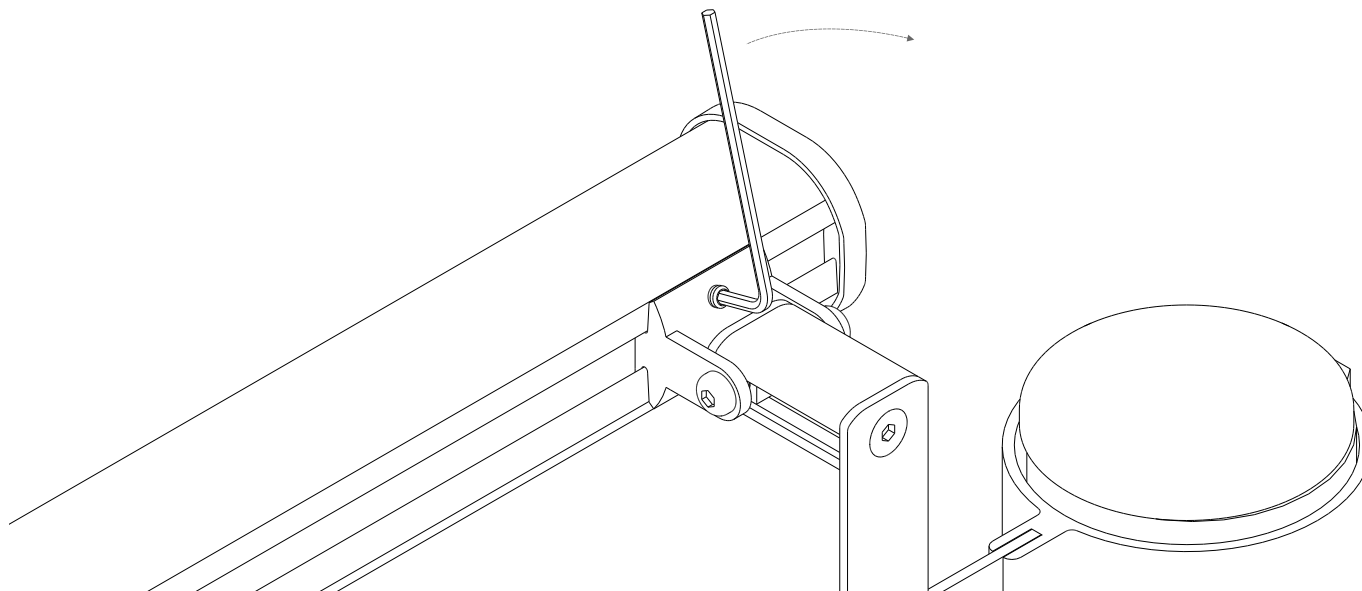

4. Connect the 3-core cable and the troughlight is complete - Get a qualified electrician to connect your 240V Cable to Mains.

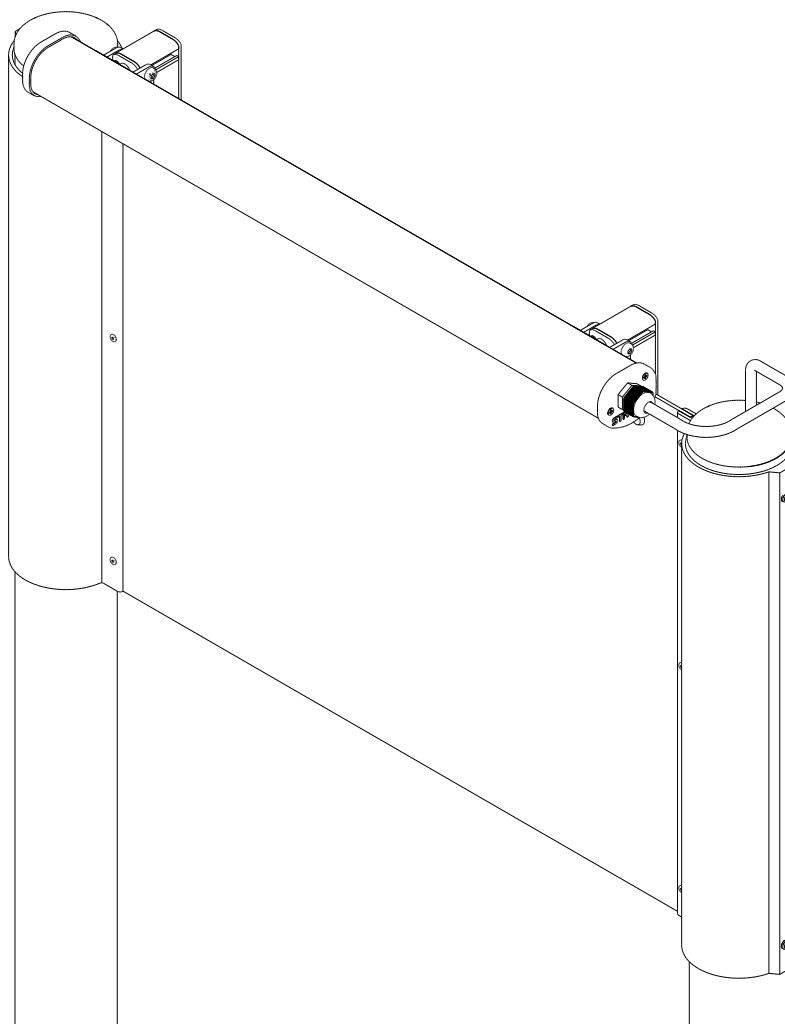

Tools Required



STRYDER_{v2} TROUGH LIGHT

Double Sided Bracket Fitting Diagram

- 1. Fixing the Bracket legs to the Top of the Double sided Plaza Tray in the desired position (Screwdriver and Allen key required)**

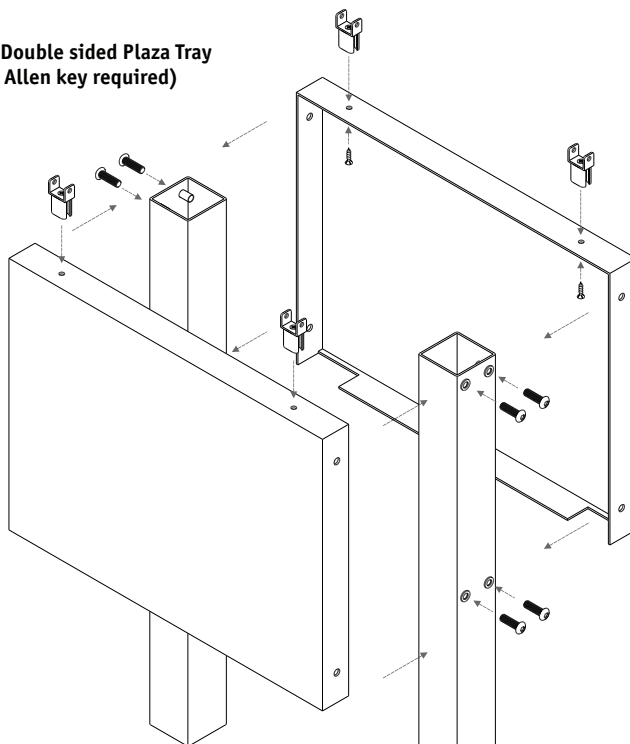

- 2. Slide the Top of the Bracket (Arm Extrusion) into position (centrally between brackets), You can then tighten into position using the External Tooth washers and M6 Bolts.**

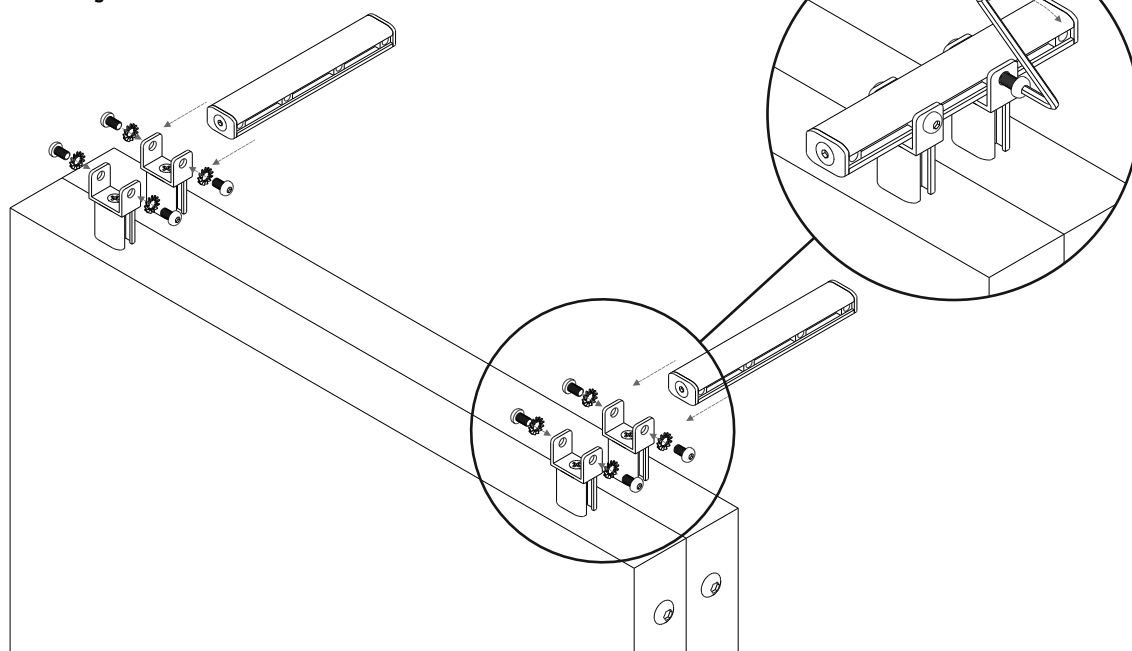

3. Slide the Main Stryder Trough Light Extrusion with the slider brackets onto the Double Sided brackets and bolt into place using the external tooth washers and M6 bolts.

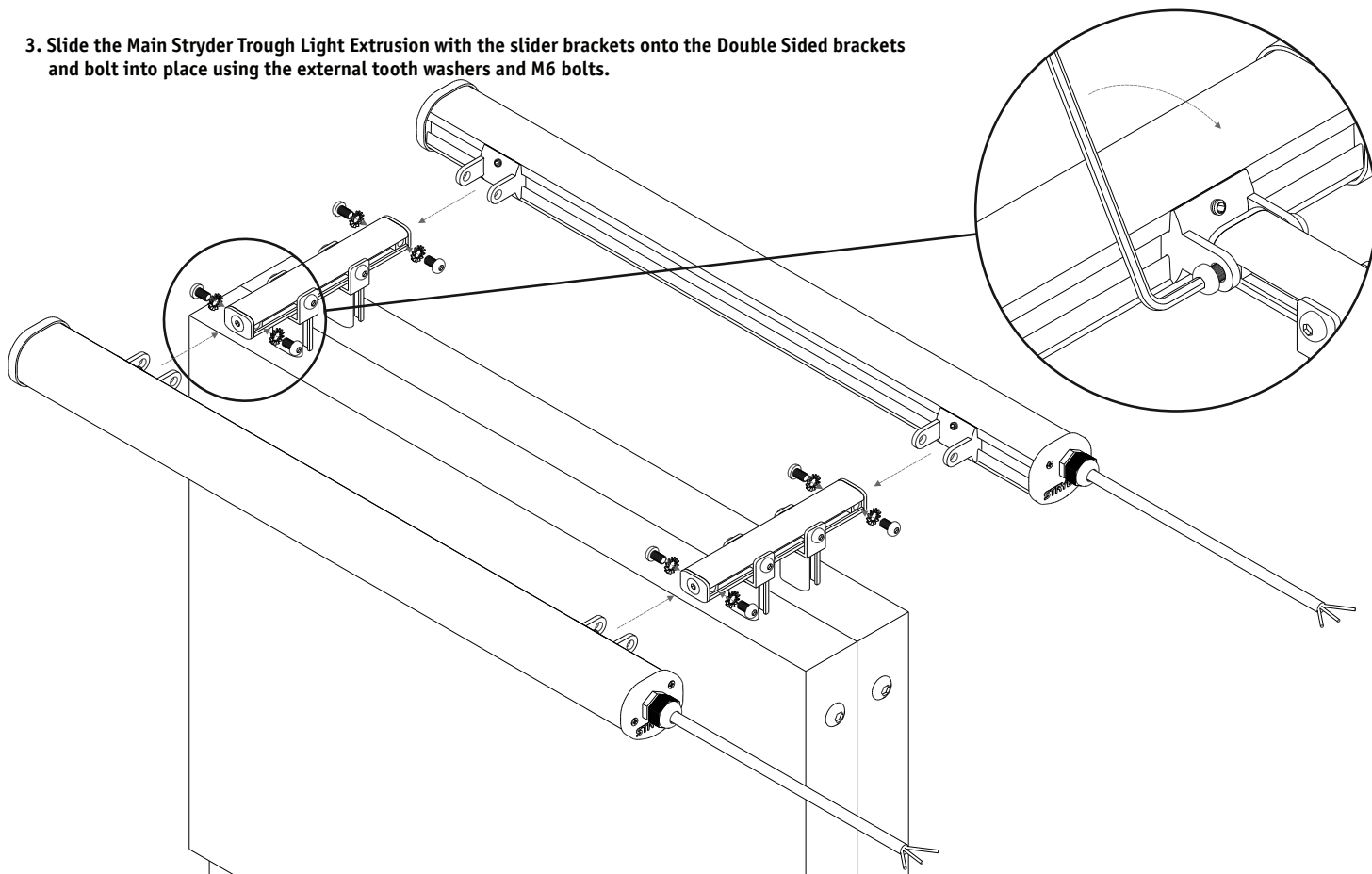

4. Slide the trough light into the correct position and then tighten the grub screws in the slider bracket to hold in place.

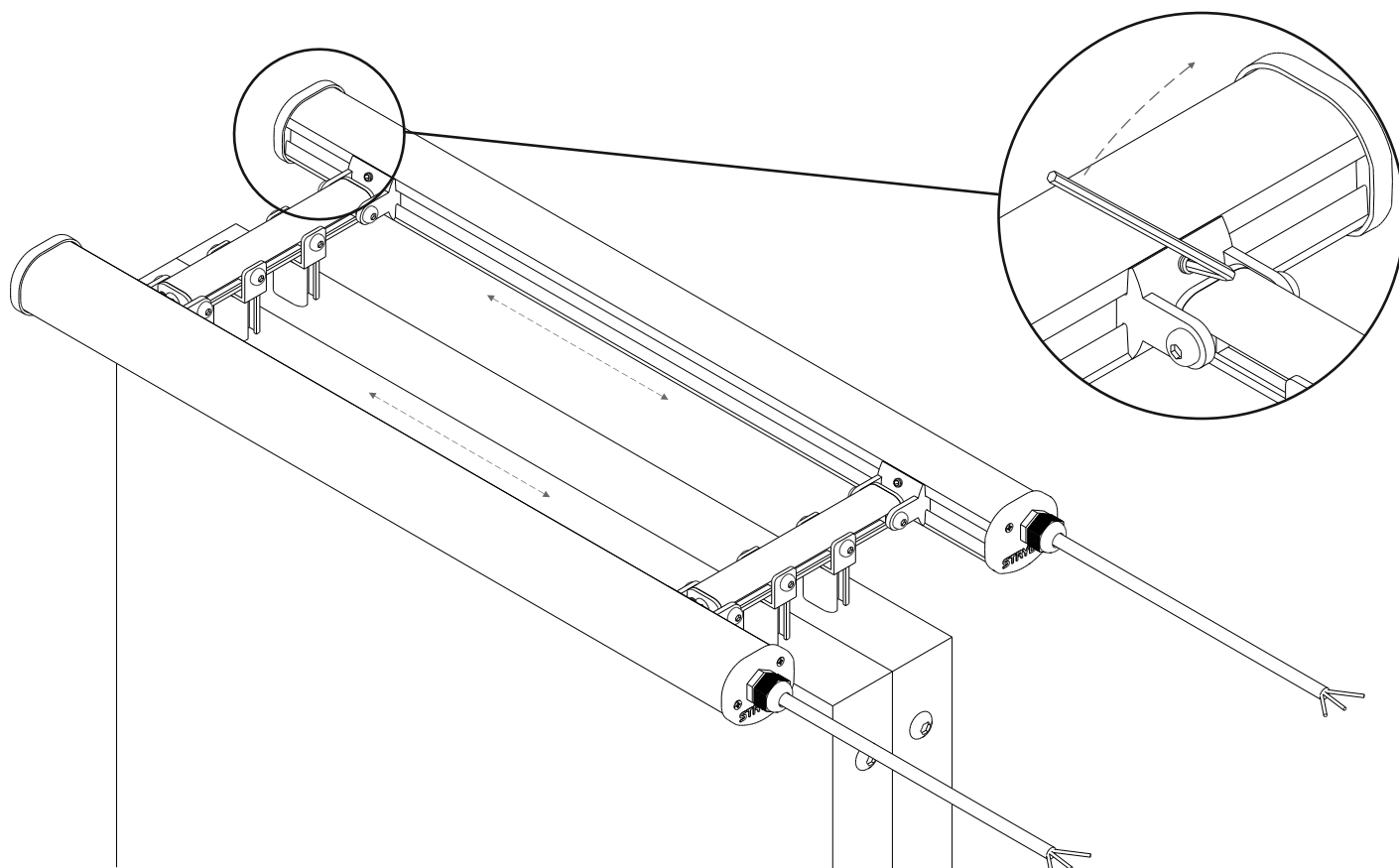

5. A Connect the 3-core cable and the troughlight is complete - Get a qualified electrician to connect your 240V Cable to Mains

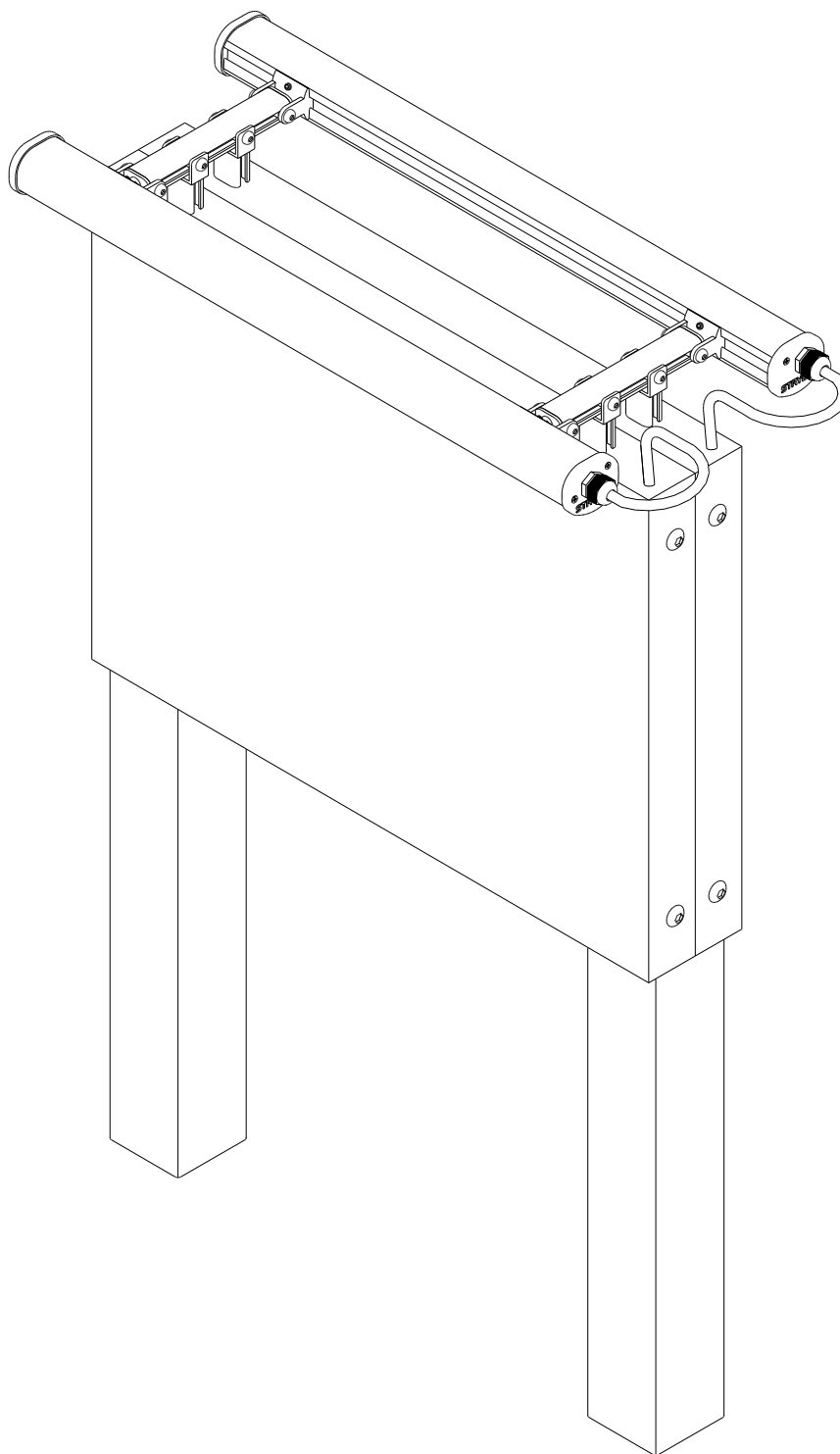

Optimum Light Chart

(Length of bracket from face of sign)
(if you are using a tray add the return depth to the bracket length)

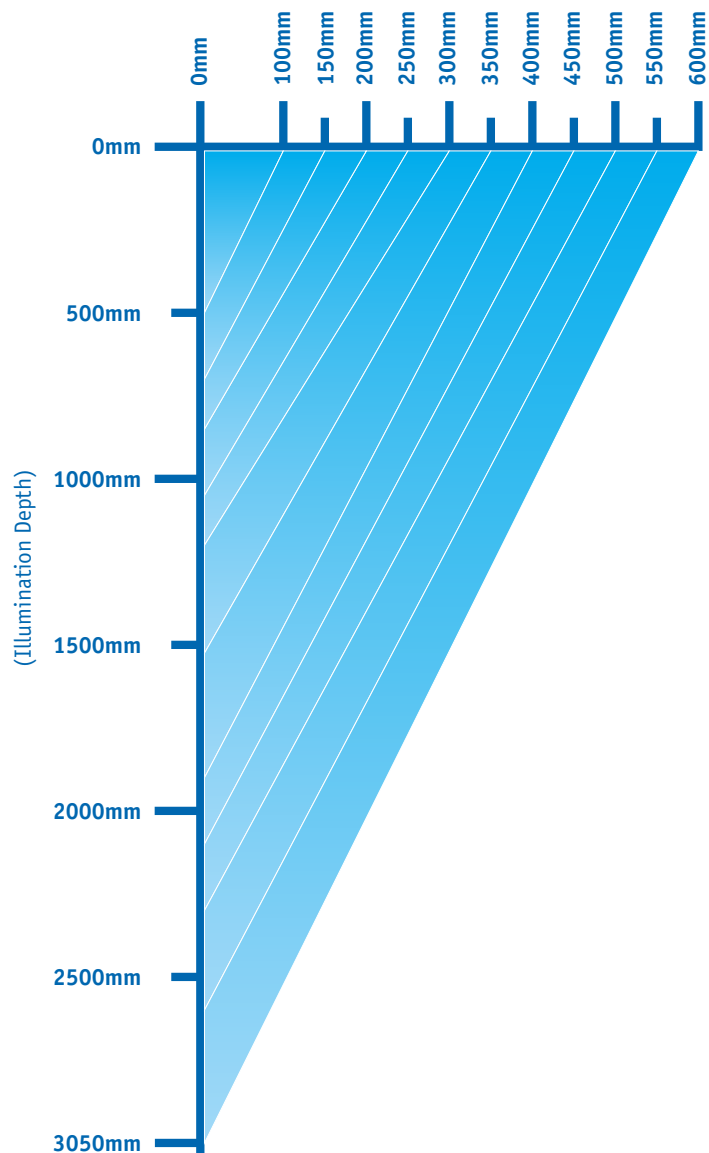

Please note: These light measurements were taken using our Cool White LED (6000K) and may differ using Warm White LED (3000K)

Wall Bracket Length Example

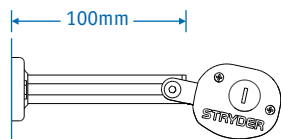

Wall Mounted Panel

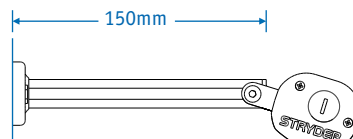

Wall Mounted Tray
(50mm added for return on tray)

