

Tools Required



BANNERFAST 90

Projecting Tension Mounted Banner System Assembly

1. Mark the position of the Top post (Step 1), drill the holes for the Anchor Bolts (Step 2)
Then place the Sleeve anchors into the holes (Step 3)

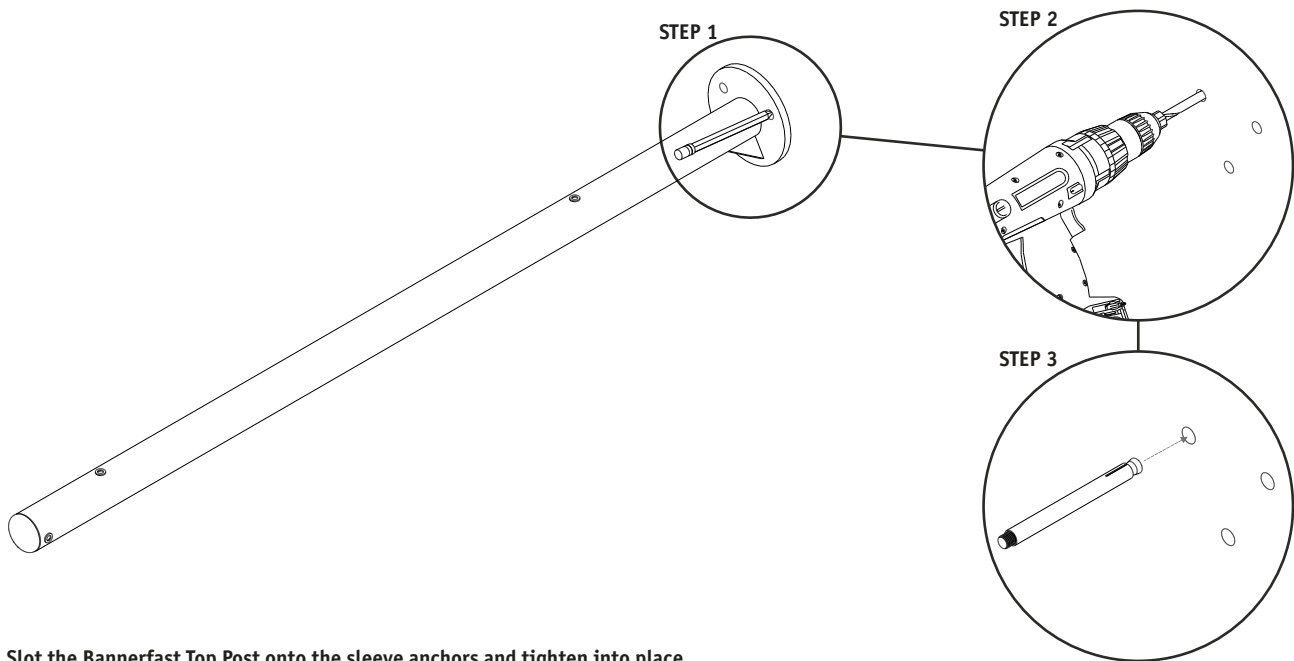

2. Slot the Bannerfast Top Post onto the sleeve anchors and tighten into place.

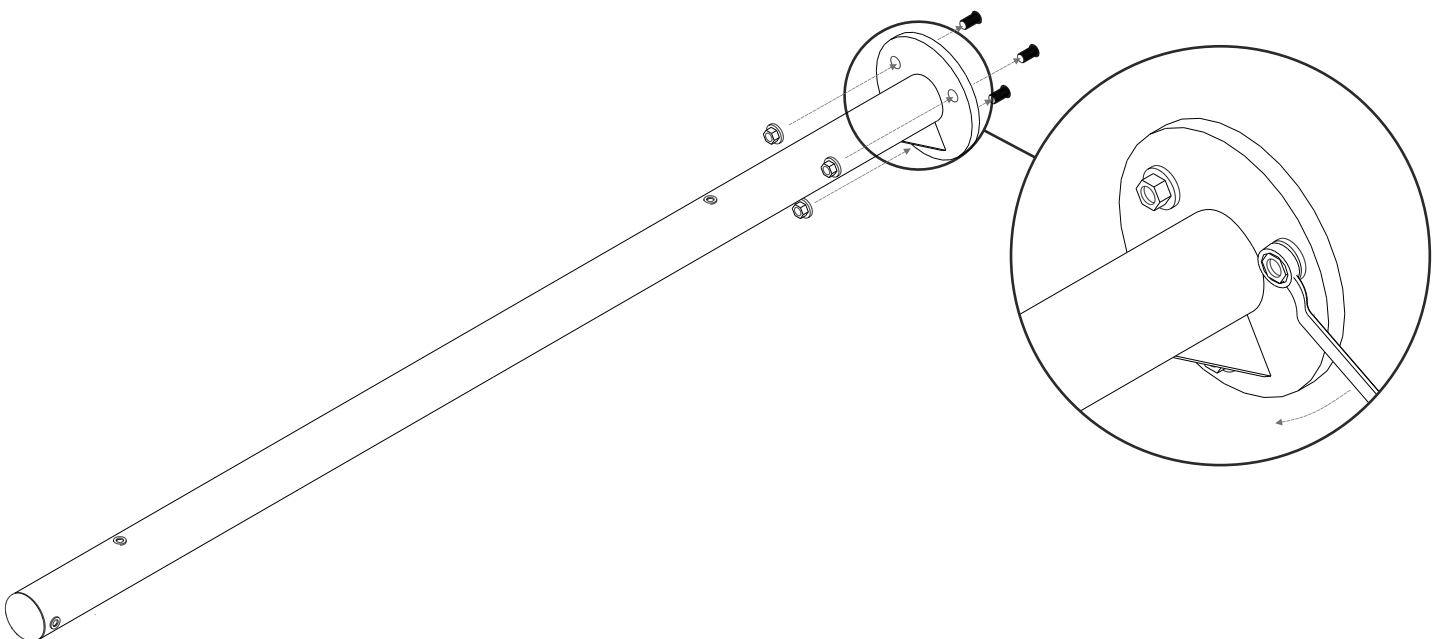

3. Slide the Banner over the Top Post, then fix in place with the M6 Dome Bolts and washers.

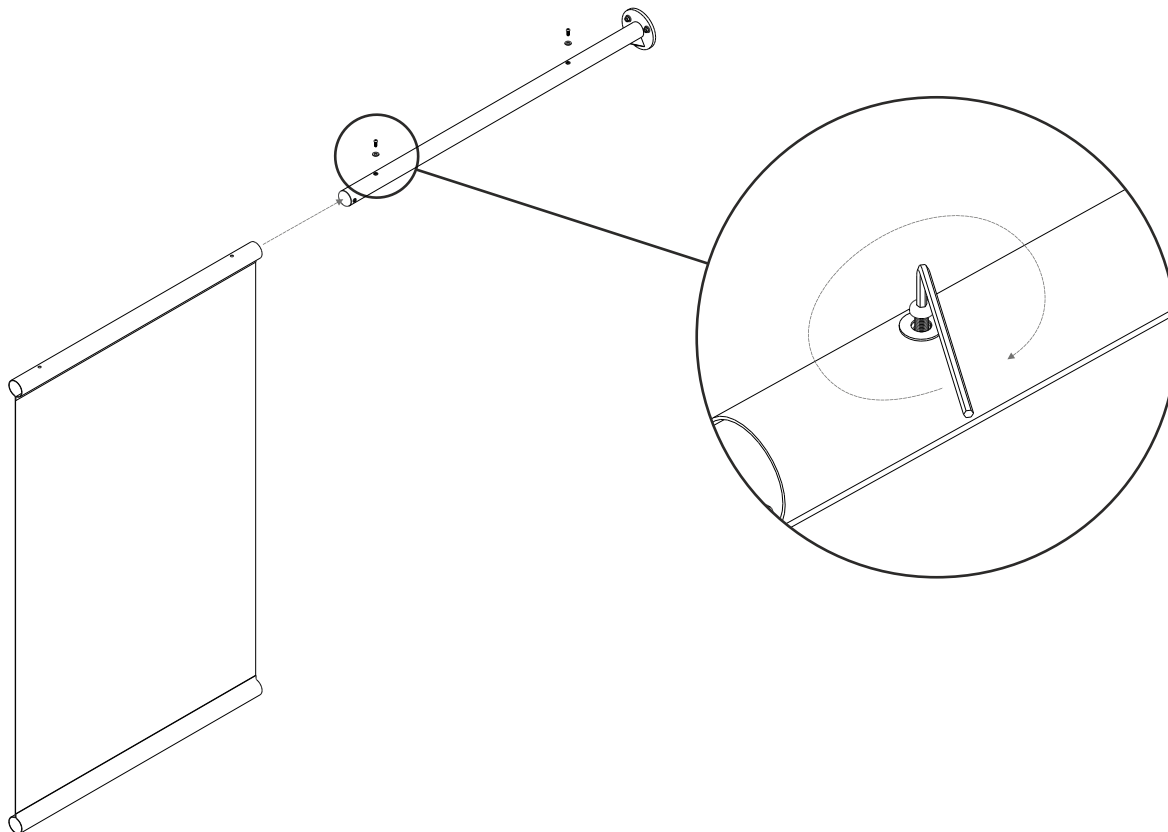

4. Slide the Middle Post (No Baseplate) into the bottom slot of the banner and stop it from sliding out using the M6 Eyebolts.

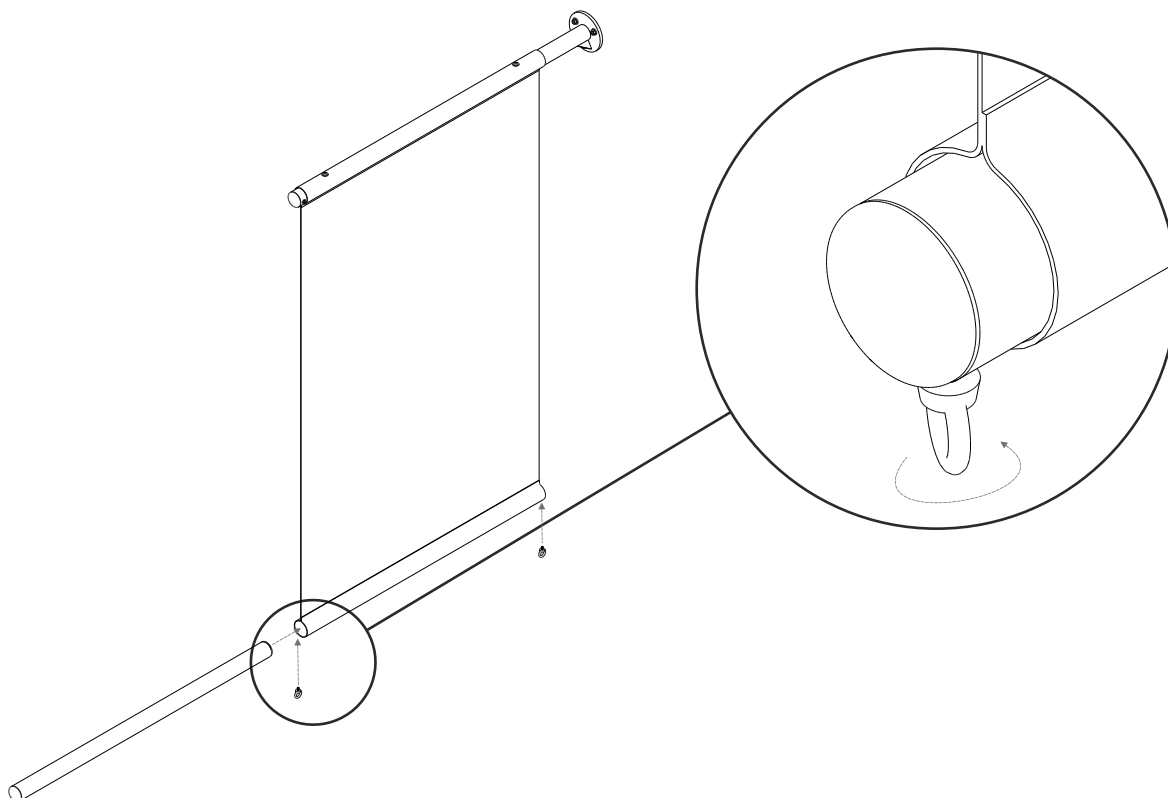

5. Connect the Bottom post to the middle post using the rigging screws (leaving the tension on the rigging screws loose).

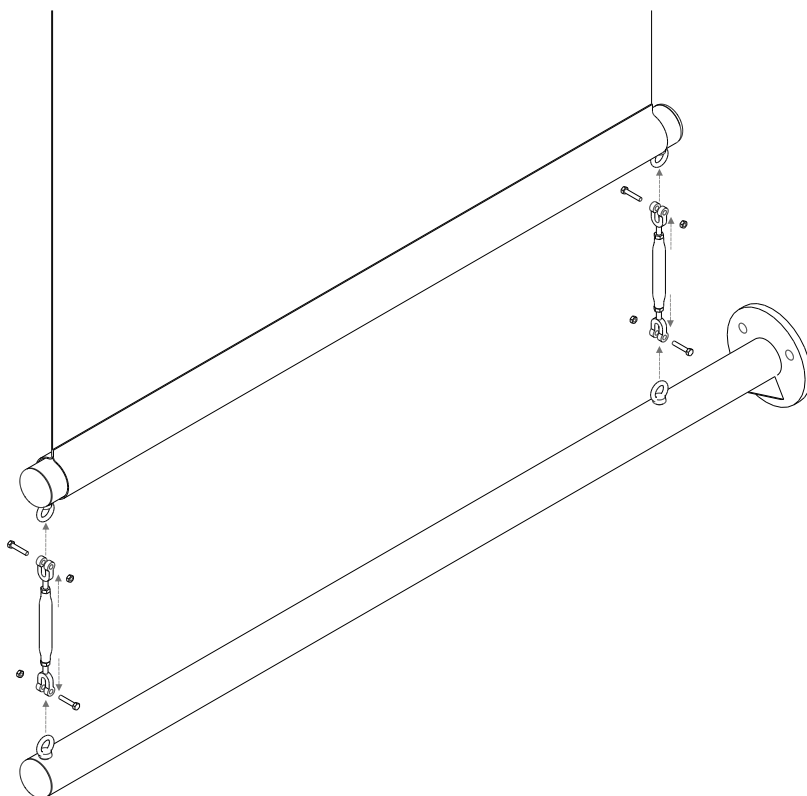

6. Mark the position of the Bottom post (Step 1), drill the holes for the Anchor Bolts (Step 2)
Then place the Sleeve anchors into the holes (Step 3)

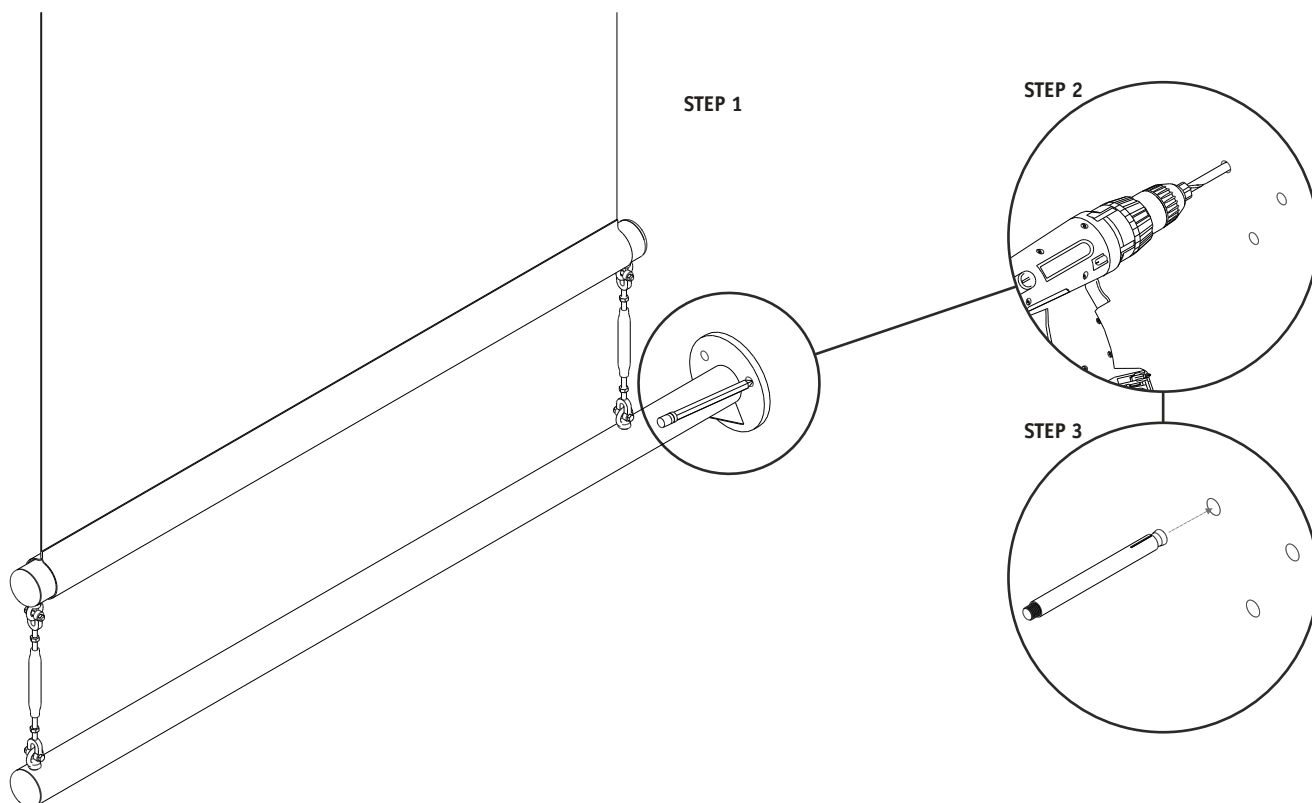

7. Slot the Bannerfast Bottom Post onto the sleeve anchors and tighten into place. Then adjust the tension on the rigging screws (Tighten) to put tension on the banner.

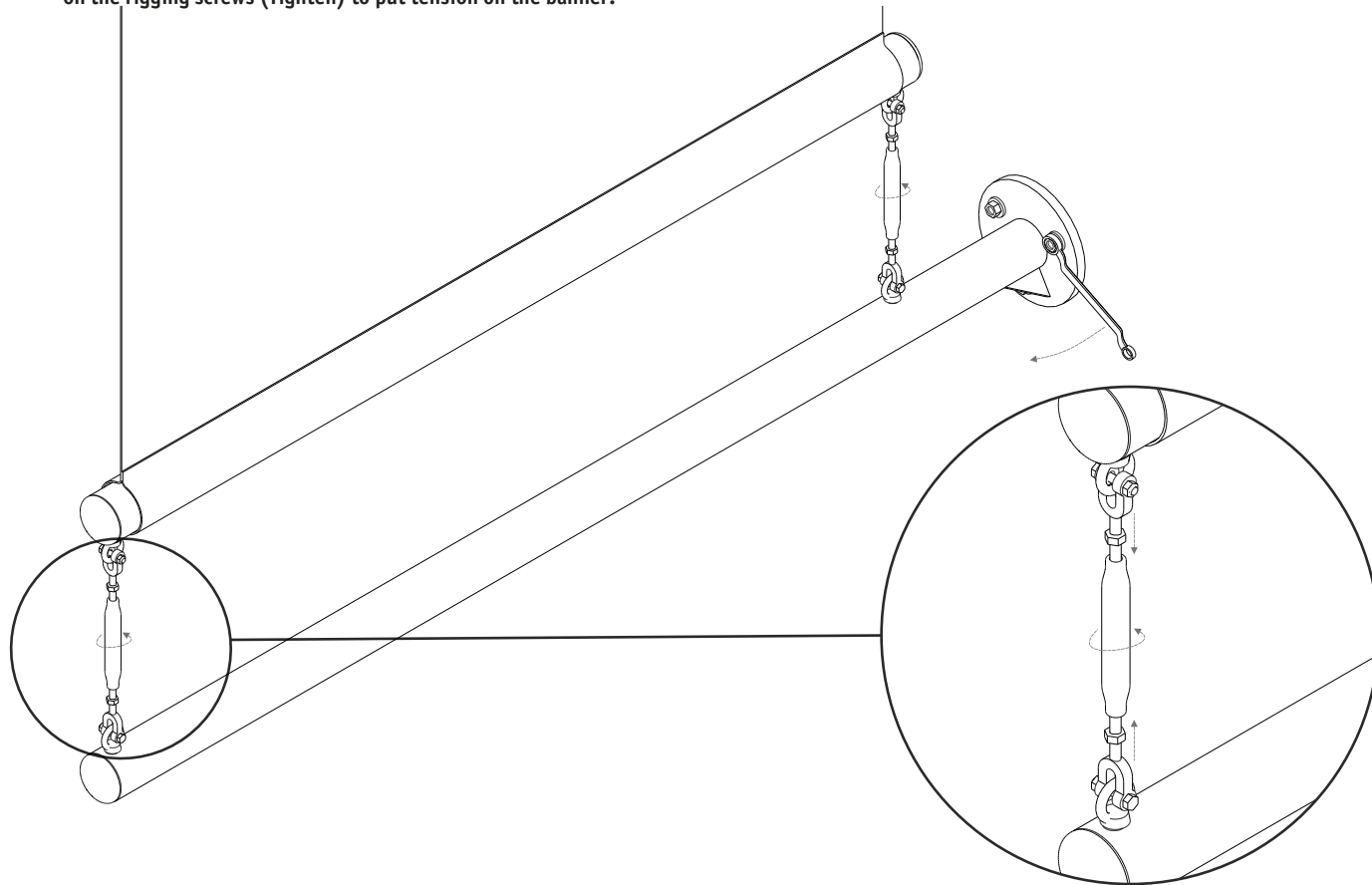

8. Your BannerFast 90 System is now fully fitted

